

MOTOR DIMENSIONS

NEMA J56 FRAME 3500 RPM

| HP | ODP | | | | | | TEFC | | | | | |
|-----|---------|------|------|---------|------|------|---------|------|------|---------|------|------|
| | 3 PHASE | | | 1 PHASE | | | 3 PHASE | | | 1 PHASE | | |
| | L | O | AB | L | O | AB | L | O | AB | L | O | AB |
| .50 | 8.26 | 6.46 | 3.32 | 9.06 | 8.37 | 3.25 | 9.48 | 7.33 | 5.87 | 9.43 | 8.10 | 5.31 |

Note: 3 phase ODP motors require base. 1 phase and TEFC motors do not.

D069J56

DRAWING DEPICTS 56J TEFC 1PHASE MOTOR

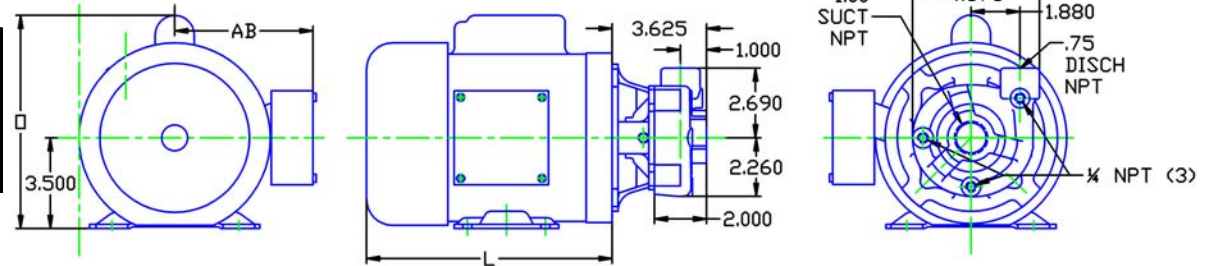

ALL DIMENSIONS IN INCHES.

DRAWING REPRESENTS APPROXIMATE PUMP DIMENSIONS. AUTOCAD DRAWING TO SCALE AVAILABLE FROM FACTORY.

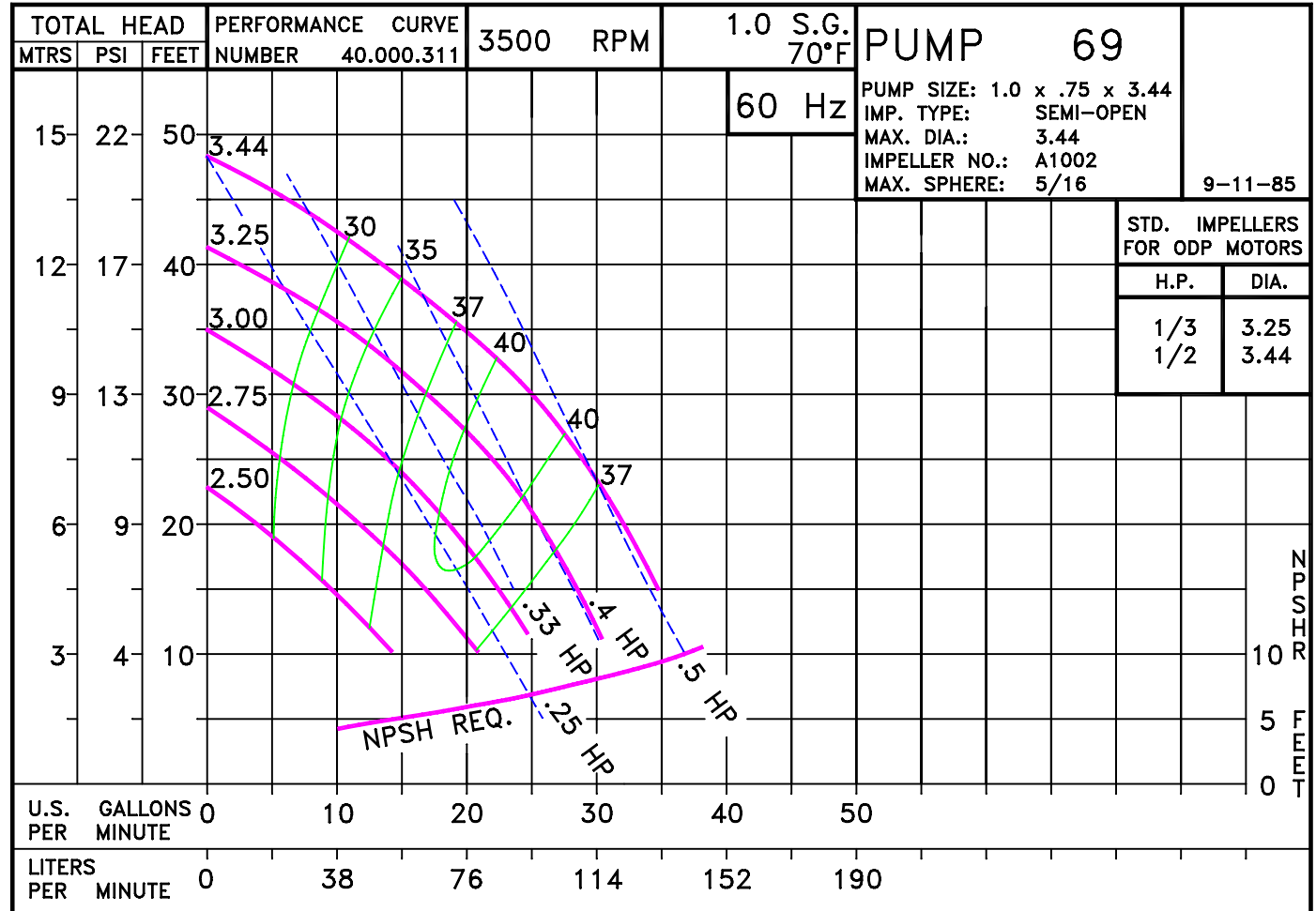
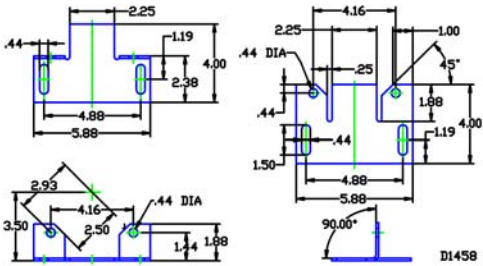

D1458 D069J56
069051TE 0693500

69 J56

0693500J56
81.001.069 K16

Pump 69 • Iron • J56 Frame • 3500 RPM

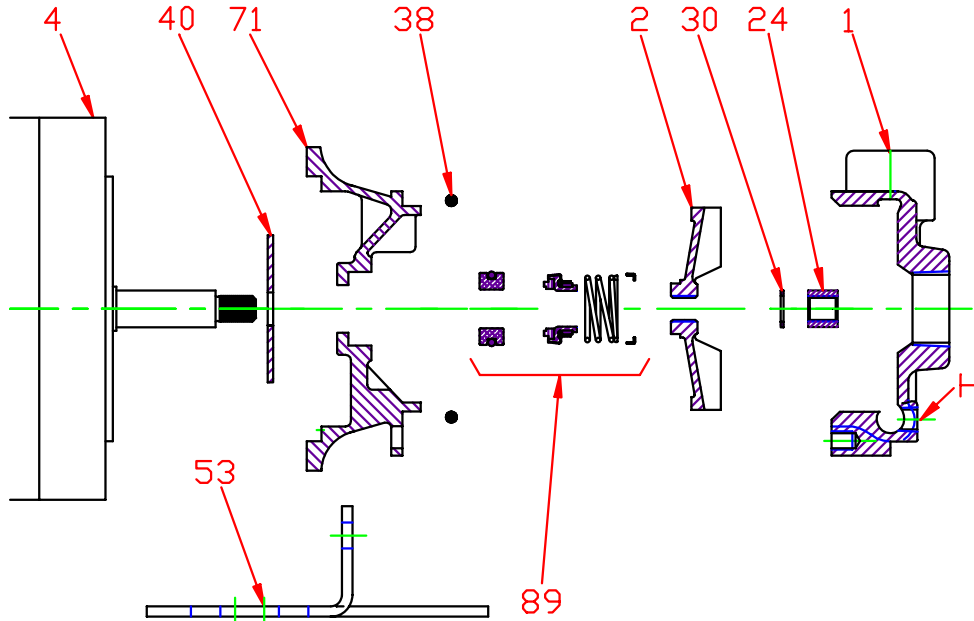

| KEY NO. | PART NAME | PUMP 69 | |
|------------------------|--|----------------|----------------|
| 1 | CASE, IRON, 1 x .75 NPT | 130.000.283AX | |
| 2 | IMPELLER, 7/16" THREADED, SEMI-OPEN, SPECIFY DIAMETER: | | |
| | IRON | 137.000.143 | |
| | BRONZE | 137.000.138 | |
| 4 | MOTOR: | | |
| | J56, ROUND BODY | See Chart | |
| | J56, 3.5" RIGID BASE | See Chart | |
| 24*+ | NUT, STAINLESS | 137.001.349 | |
| 30*+ | D WASHER, STAINLESS | 104.000.168 | |
| 40* | FLINGER, NEOPRENE | 104.000.171 | |
| 53 | BASE, STEEL | 119.000.287A | |
| 71 | ADAPTER, IRON | 132.000.298X | |
| 73* | GASKET, CASE, BUNA | 116.000.153 | |
| 89* | 5/8" SEALS: | | |
| | NO RETAINER: (not shown) | | |
| | TYPE 6, BN-CARB/CM | 101.000.110 | |
| | WITH RETAINER: | | |
| | TYPE 21, VN-CARB/CM | 101.000.103 | |
| | TYPE 21, VN-CARB/SIL | 101.000.120 | |
| | TYPE 21, VN-SIL/SIL | 101.000.239 | |
| | TYPE 21, EPDM-CARB/CM | 101.000.327 | |
| TYPE 21, EPDM-CARB/SIL | 101.000.173 | | |
| TYPE 21, EPDM-SIL/SIL | 101.000.236 | | |
| -- | REPAIR KITS: | | |
| | | 3 PHASE: | 1 PHASE: |
| | BN-CARB/CM SEAL | 118.000.389 | 118.000.389.1 |
| | VN-CARB/CM SEAL | 118.000.389A | 118.000.389A.1 |
| | VN-CARB/SIL SEAL | 118.000.389B | 118.000.389B.1 |
| | VN-SIL/SIL SEAL | 118.000.389E | 118.000.389E.1 |
| | EPDM-CARB/CM SEAL | 118.000.389F | 118.000.389F.1 |
| | EPDM-CARB/SIL SEAL | 118.000.389C | 118.000.389C.1 |
| EPDM-SIL/SIL SEAL | 118.000.389D | 118.000.389D.1 | |

* DENOTES COMPONENTS INCLUDED IN REPAIR KIT.
 + NOT REQUIRED ON 1/3 TO 1-1/2 HP 1 PHASE MOTORS.

Pump 69 • J56 Frame • 3500 RPM

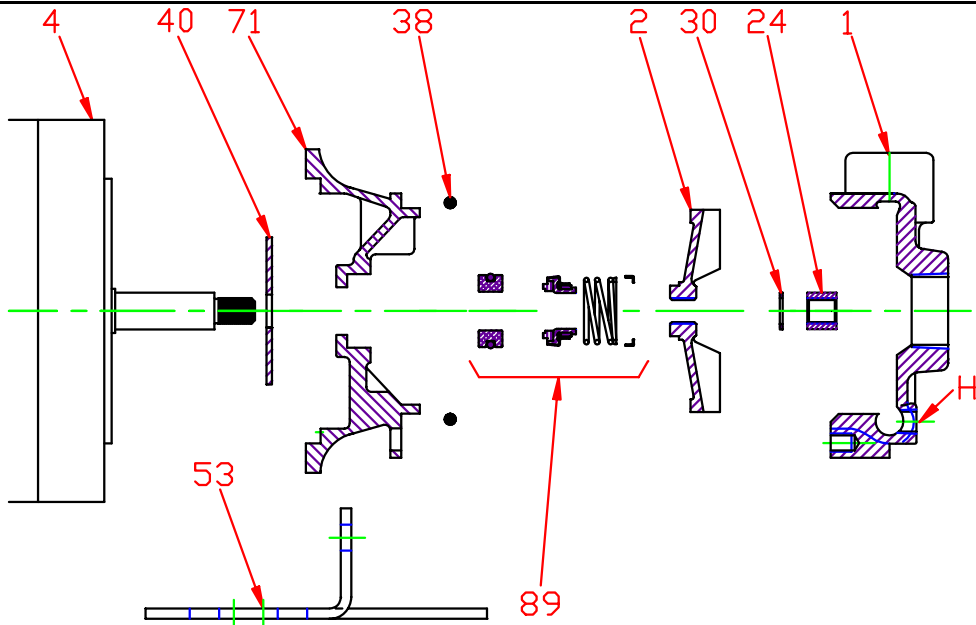

| CONSTRUCTION OPTIONS | | | | |
|----------------------|--------------------------------|-----------------|---------------|-----------|
| KEY | PART NAME | STANDARD FITTED | BRONZE FITTED | ALL IRON |
| 1 | Case | Iron | Iron | Iron |
| 2 | Impeller | Iron | Bronze | Iron |
| 24 | Impeller Locknut | Stainless | Stainless | Stainless |
| 30 | D-Washer | Stainless | Stainless | Stainless |
| 40 | Flinger | Neoprene | Neoprene | Neoprene |
| 53 | Base | Steel | Steel | Steel |
| 71 | Adapter | Iron | Iron | Iron |
| 73 | Gasket, Case | Buna | Buna | Buna |
| 89 | Mechanical Seal, Type 6, BN-CM | Standard | Standard | Standard |
| H | Plug, Drain | Brass | Brass | Plated |

E069J56

E11

C0693500J56